

The Ashtons logo is displayed in white text on a dark blue rectangular background in the top right corner. The letter 'A' is stylized with a green leaf-like shape extending from its left side.

46 Rowntree Wharf, Navigation Road YO1 9XA

£1,250 Per Month

2



1



1



C



This wonderful two bedroom apartment boasts an enviable riverside position in the heart of York City centre. The property is offered on a furnished basis and set on the third floor, with lift access. The accommodation comprises; Entrance hallway, generous reception space with ample room for living and dining areas with open plan fitted kitchen with breakfast bar and integrated fridge freezer, dishwasher, oven, hob, microwave and freestanding washing machine. The main bedroom has a king size bed and fitted wardrobe, the second bedroom has a day bed and fitted wardrobe and a three piece bathroom suite with shower over the bath. The property also benefits from allocated, secure parking.

Available 6th May 2026

EPC RATING C / Deposit £1350 / Council Tax Band D

FOURTH FLOOR  
649 sq.ft. (60.3 sq.m.) approx.

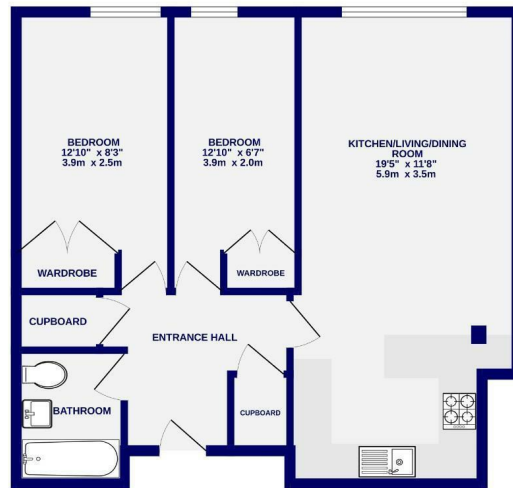

TOTAL FLOOR AREA: 649 sq.ft. (60.3 sq.m.) approx.  
 Whilst every attempt has been made to ensure the accuracy of the floorplan, measurements of rooms and any other details are approximate, it is advised to visit the property with your agent if you are interested.  
 This plan and all measurements are for information only and do not constitute an offer of any property. The plan, layout and appearance shown may not be exactly as depicted and is subject to change without notice.  
 Made with Matterport 2023



Ashtons Lettings



01904 731404



lettings@ashtonsnet.com

